

200V/20A Silicon Carbide Schottky Diode

Features

- Positive temperature co-efficient
- Temperature-independent switching behavior
- Operation temperature up to 175°C
- Zero reverse recovery current
- Zero forward recovery voltage

SC3S12020B

Description		
V_{RRM}	1200	V
$I_F, T_c \leq 135^\circ\text{C}$	12.5 (per leg)	A
Q_c	138	nC

Benefits

- Unipolar rectifiers
- Essentially no switching losses
- Parallel devices without thermal runaway
- Reduction of heat sink requirements

Applications

- SMPS, PFC
- Motor driving, PV inverter, UPS, Wind engine, Rail traction, EV/HEV.

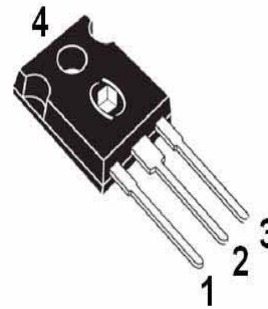

Package:
TO-247

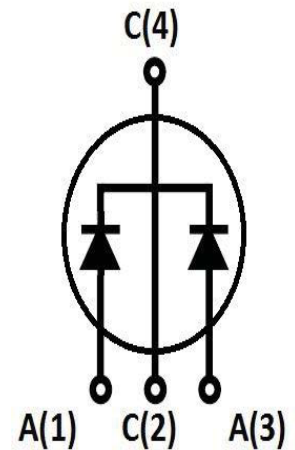

Part Number	Package	Marking
SC3S12020B	TO-247-3 pin	12020B

Maximum Ratings (Tc=25°C unless otherwise specified)

Parameter	Symbol	Test conditions	Value	Unit
Repetitive Peak Reverse Voltage	V_{RRM}		1200	V
Surge Peak Reverse Voltage	V_{RSM}		1200	
DC Blocking Voltage	V_{DC}		1200	
Continuous Forward Current	I_F	$T_C=25^\circ\text{C}$ $T_C=135^\circ\text{C}$ $T_C=155^\circ\text{C}$	25.9* 12.5* 10*	A
Repetitive Peak Forward Surge Current	I_{FRM}	$T_C=25^\circ\text{C}$, $t_p=10\text{ms}$, Half Sine Wave, $D=0.3$	50*	A
Non-repetitive Peak Forward Surge current	I_{FSM}	$T_C=25^\circ\text{C}$, $t_p=10\text{ms}$, Half Sine Wave	100*	A
Power Dissipation	P_{TOT}	$T_C=25^\circ\text{C}$	141.5*	W
		$T_C=110^\circ\text{C}$	62*	W
Operation temperature	T_j		-55°C to 175°C	°C
Storage temperature	T_{stg}		-55°C to 175°C	°C
Mounting Torque		M3 Screw	1	Nm
		6-32 Screw	8.8	lbf-in

Thermal Characteristics

Parameter	Symbol	Test condition	Value	Unit
			Typical	
Thermal resistance from Junction to Case	$R_{th\text{JC}}$		1.06* 0.53**	°C/W

Electrical Characteristics

Parameter	Symbol	Test Condition	Value		Unit
			Typ.	Max.	
Forward voltage	V_F	$I_F=10\text{A}$, $T_j=25^\circ\text{C}$	1.63	1.7	V
		$I_F=10\text{A}$, $T_j=175^\circ\text{C}$	2.55	3	
Reverse current	I_R	$V_R=1200\text{V}$, $T_j=25^\circ\text{C}$	50	100	µA
		$V_R=1200\text{V}$, $T_j=175^\circ\text{C}$	100	200	
Total capacitive charge	Q_C	$V_R=800\text{V}$, $T_j=150^\circ\text{C}$ $Q_C = \int_0^{V_R} C(V)dV$	69	-	nC
Total capacitance	C	$V_R=0\text{V}$, $T_j=25^\circ\text{C}$, $f=1\text{MHZ}$	770	790	pF
		$V_R=400\text{V}$, $T_j=25^\circ\text{C}$, $f=1\text{MHZ}$	52	54	
		$V_R=800\text{V}$, $T_j=25^\circ\text{C}$, $f=1\text{MHZ}$	50	51	

RATING AND CHARACTERISTICS CURVES (SC3S12020B)

1) Forward characteristics

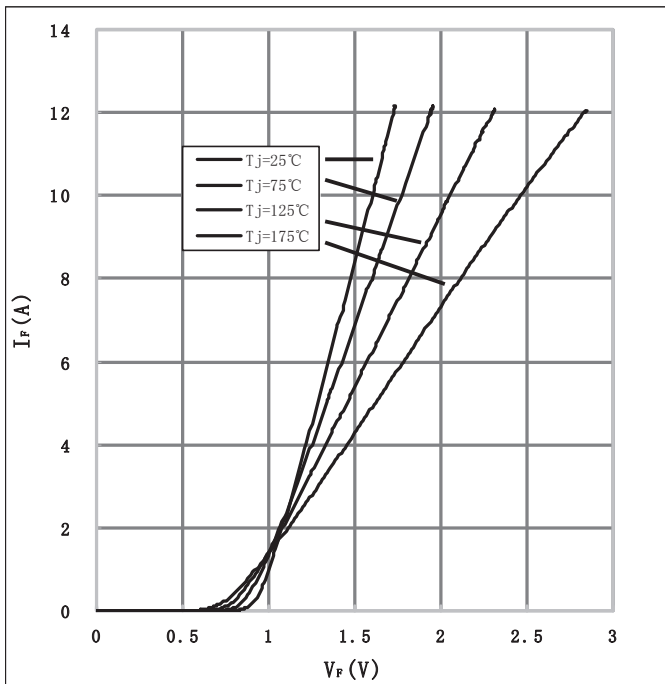

2) Reverse characteristics

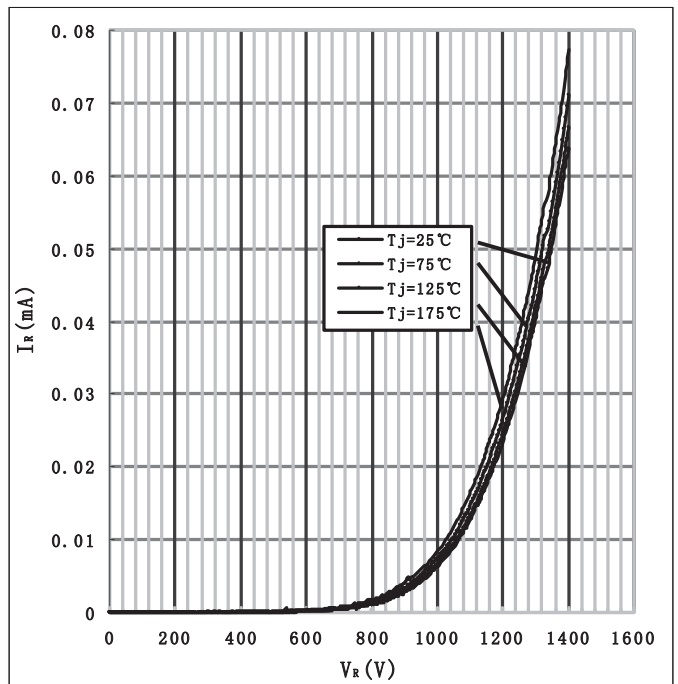

3) Current Derating

(10%, 30%, 50%, 70% Duty ,DC)

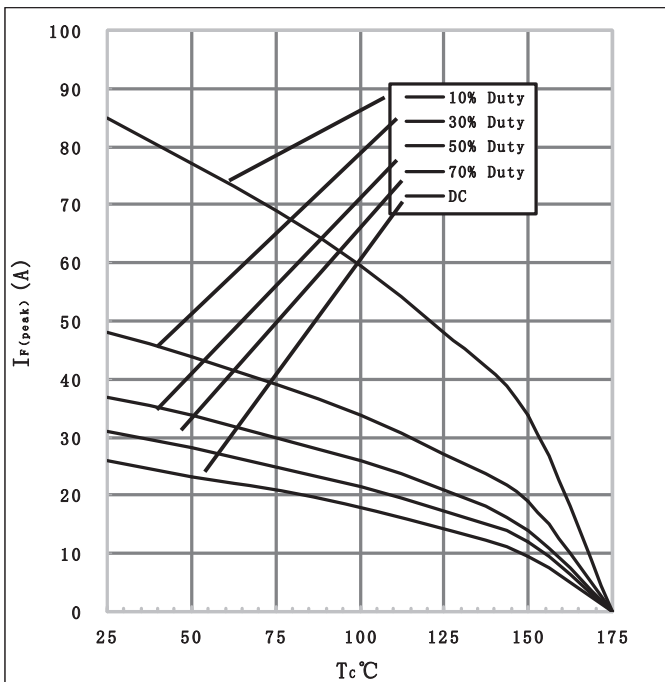

4) Capacitance vs. Reverse voltage

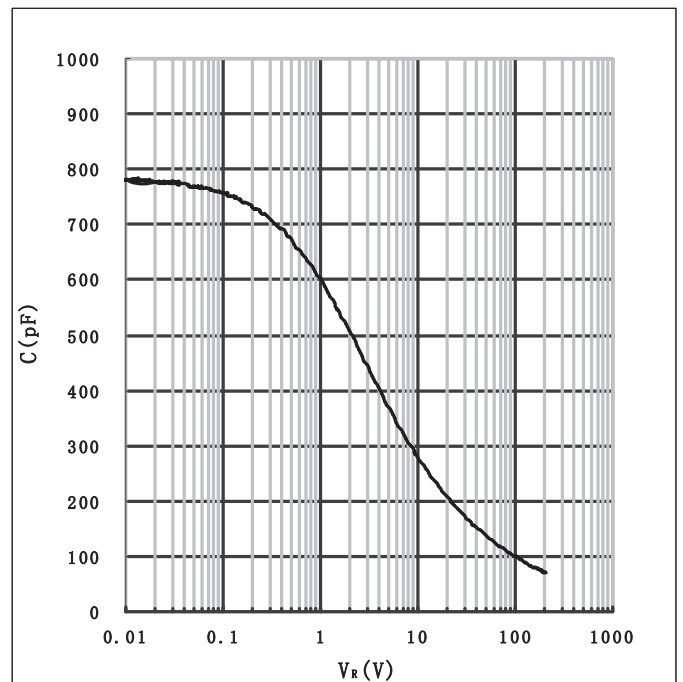

TO-247

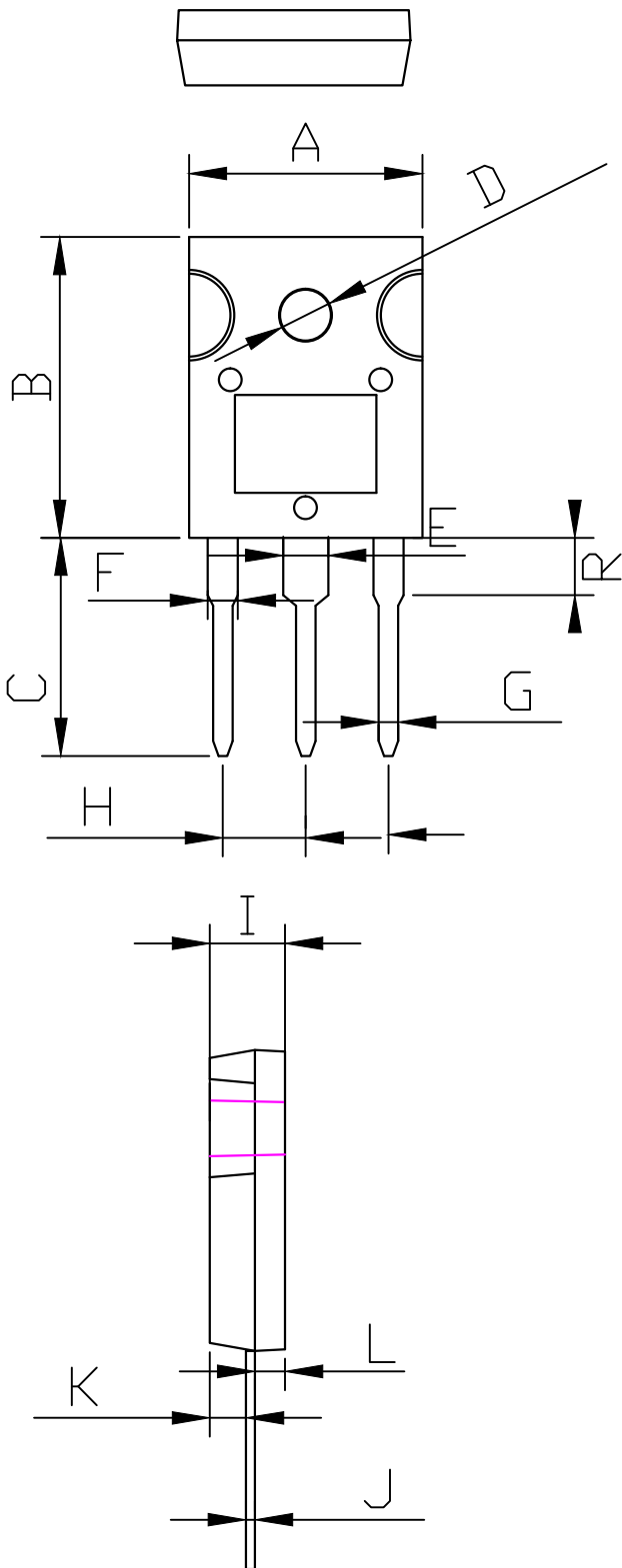

项目	mm		
	标准值	Min	Max
A	15.5	15.45	15.55
B	20	19.9	20.1
C	14.5	14.4	14.6
D	3.5	3.3	3.6
E	3	2.95	3.05
F	2	1.95	2.05
G	1.3	1.2	1.4
H	5.5	5.4	5.6
I	5	4.95	5.05
J	0.6	0.58	0.62
K	2.4	2.3	2.5
L	2	1.9	2.1
R	3.8	3.6	4

DISCLAIMER NOTICE

Rectron Inc reserves the right to make changes without notice to any product specification herein, to make corrections, modifications, enhancements or other changes. Rectron Inc or anyone on its behalf assumes no responsibility or liability for any errors or inaccuracies. Data sheet specifications and its information contained are intended to provide a product description only. "Typical" parameters which may be included on RECTRON data sheets and/ or specifications can and do vary in different applications and actual performance may vary over time. Rectron Inc does not assume any liability arising out of the application or use of any product or circuit.

Rectron products are not designed, intended or authorized for use in medical, life-saving implant or other applications intended for life-sustaining or other related applications where a failure or malfunction of component or circuitry may directly or indirectly cause injury or threaten a life without expressed written approval of Rectron Inc. Customers using or selling Rectron components for use in such applications do so at their own risk and shall agree to fully indemnify Rectron Inc and its subsidiaries harmless against all claims, damages and expenditures.

Mouser Electronics

Authorized Distributor

Click to View Pricing, Inventory, Delivery & Lifecycle Information:

[Rectron:](#)

[SC3S12020B](#)